

The background features a photograph of a modern, two-story industrial-style building with large glass windows and dark panels. The building has "HAMLIN CTE" and "WOOD SHOP" visible on its facade. In the foreground, there is a parking lot with several cars parked. The entire image is overlaid with a semi-transparent blue filter.

# HAMLIN HIGH SCHOOL ADDITION OPEN HOUSE

08/21/2023

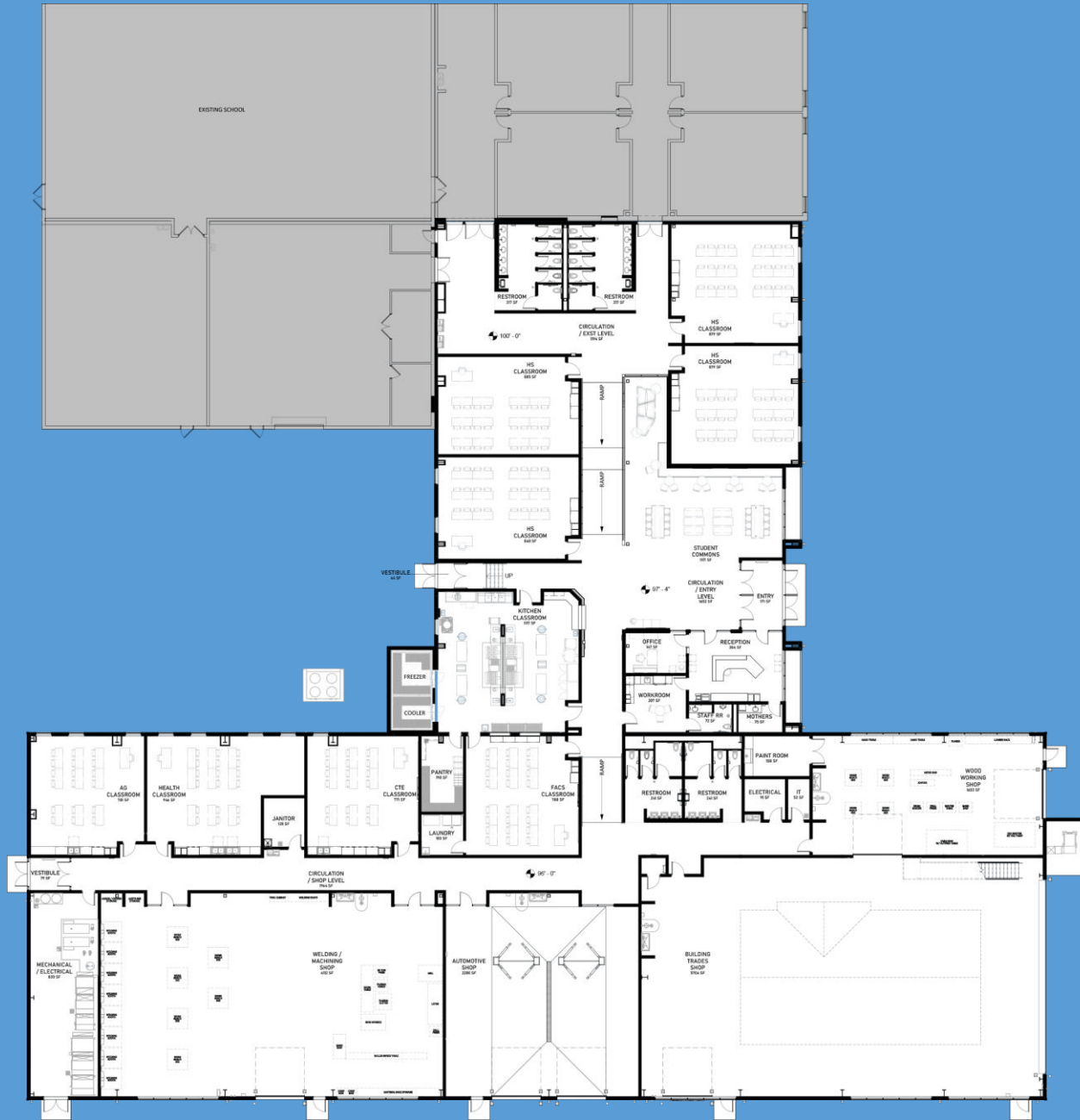

This is an informative meeting.

- This will have NO board action at the end of this meeting.
- At the current guaranteed price of the building, a vote is NOT needed to build the building.

# School Board

- Joe Homola
- Neal Opdahl
- Tara Abraham
- Sherri Stormo
- Crystal Nelson

# Building Committee

- Joe Homola
- Sherri Stormo
- Jim Hulscher
- Jeff Sheehan
- Donae VanNorden
- Boyd Knutson
- Ryan Stormo
- Kendall Wendling

# Why do this addition?

- We need space and more classrooms, elementary is busting at the seams. Teachers and staff are working in areas designated as office, closet or storage originally.
- NTHS is not that popular with Hamlin students and is costing the district more per pupil to remain a part of it.
- Our current shop is very tight and not safe for all projects to be happening.
- We have limited spots available for our students on site and there is a high demand for the classes locally.

# Why do this addition?

- The current FACS kitchen does NOT meet the code by the fire marshal and needs other updates as well.
- Middle School students do NOT have any options to take these classes at this time.
- To prepare and equip our students to become responsible citizens and succeed in an ever-changing world. -- Hamlin School Motto

# Enrollment K- 12

- 2024 – 856 (projected next year)
- 2023 – 845 (projected)
- 2022 – 835
- 2021 – 838
- 2020 – 847
- 2019 – 842
- 2018 - 810
- 2017 – 783
- 2016 – 749
- 2015 – 727
- 2014 – 726
- 2013 – 715
- 2012 – 677
- 2011 – 696
- 2010 – 681
- 2009 - 687
- 2008 - 658
- 2007 - 652
- 2006 - 622
- 2005 - 644
- 2004 - 618
- 2003 - 594
- 2002 – 646
- 2001 - 660

# Enrollment (K-12)

- If you look at trends...
- In the 22-23 school year
  - K-6 averaged 68 students per class
  - 7-12 averaged 58 students per class



# NTHS – Multi District

- NTHS enrollment of Hamlin High School Students have declined over the years
- 22-23 school year: 15 students
- 23-24 school year: 11 students
- It will cost the Hamlin School District approximately \$85,000 to be a member of NTHS.
- This does not include the driver or the busing them to and from Watertown.

- CURRENT SHOP WOULD BE USED FOR MIDDLE SCHOOL CTE CLASSES
- Some of the equipment in the current shop, like the hoist will be moved into one of the new shops

# New High School Addition

- It will be attached to the south end of the building. The hallway alongside gymnasium 2 & 3 will connect along with the hallway to the east.
- 8 Classrooms
- 4 shop areas
- FACS Kitchen
- Commons Area
- Office area
- Restrooms

# New High School Addition (8 Classrooms)

## - 4 extra classrooms

- Have NOT identified these classrooms other than High School classrooms
- With this 5<sup>th</sup> grade would eventually move giving elementary more rooms
- 5<sup>TH</sup> grade would NOT be a part of the middle school concept. 5<sup>th</sup> grade would still be considered elementary
- 4 other Classrooms:
  - Ag/FFA Classroom
  - FACS Classroom
  - CTE Classroom
  - Health Science/Human Resources

# New High School Building (4 shops)

1. Shop – big enough to build a house in it (eventually)
2. Wood shop – for other lower level classes and smaller project classes
3. Welding Shop – for welding classes (keeping them separate from the woodworking shop)
4. Automotive Shop

# New High School Building (FACS Kitchen)

- 4 kitchen stations with more space for working effectively
- Industrial kitchens
- Meets code

# New High School Building

- Open up the option to area schools if interested to attend
- Goal: Completed by 24-25 School Year (Aggressive timeline)

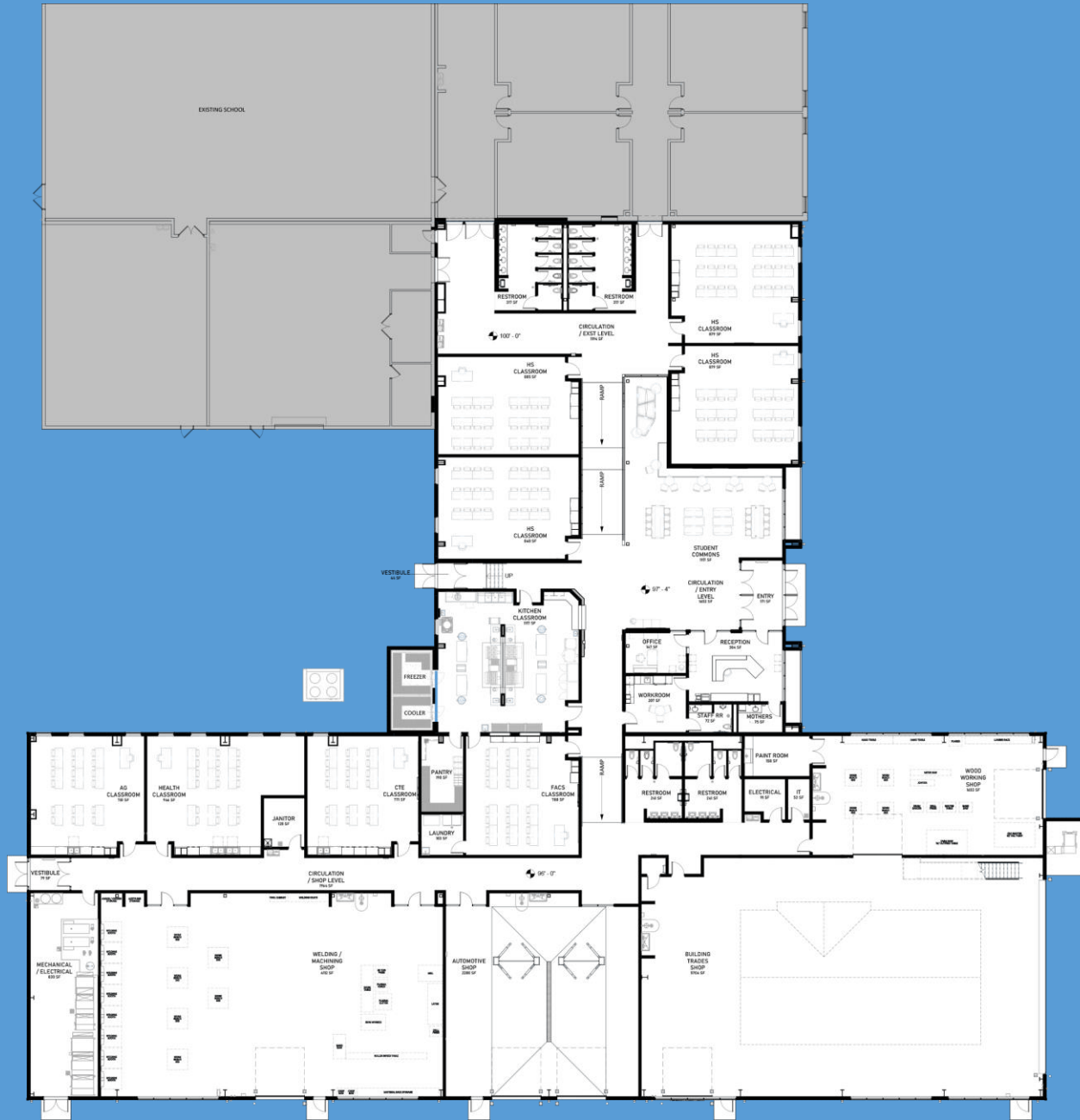



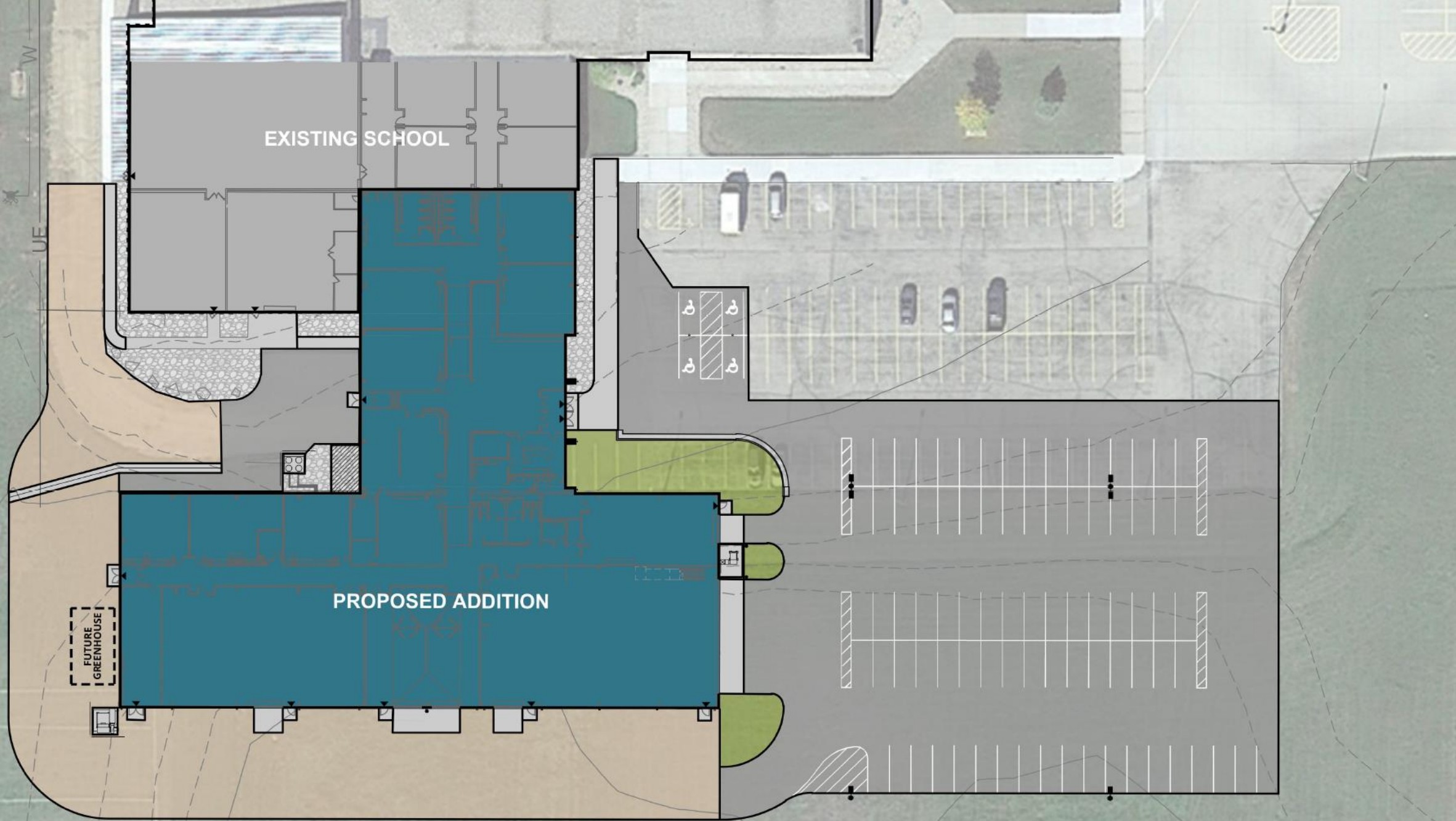

EXISTING SCHOOL

PROPOSED ADDITION

FUTURE GREENHOUSE



HAMLIN CTE

WOOD SHOP

HAMLIN HIGH SCHOOL  
CAREER AND TECHNICAL EDUCATION BUILDING

CO  
OP





CO  
OP





CO  
OP



HAMLIN  
HIGH  
SCHOOL



DON'T BE AFRAID OF THE FUTURE

CO  
OP





HAMLIN  
HIGH  
SCHOOL

DON'T BE AFRAID OF THE FUTURE. **BUILD IT.**

CO  
OP

# High School Addition

- As a new administrator, the Hamlin School has been preparing for this addition.
- The goal is to not increase your tax levies to build this building.
- The guaranteed maximum price is \$10.54 million

# Levy's of the Hamlin District

Payable	type	Total Levy		Payable	Type	Total Levy
2023	General Ag	5.264		2020	General Ag	5.596
2023	General OO	6.950		2020	General OO	7.419
2023	General NA	10.210		2020	General NA	10.944
2022	General Ag	5.617		2019	General Ag	5.562
2022	General OO	7.361		2019	General OO	7.433
2022	General NA	10.733		2019	General NA	11.051
2021	General Ag	5.696		2018	General Ag	5.56
2021	General OO	7.482		2018	General OO	7.425
2021	General NA	10.935		2018	General NA	11.031



The goal is to not increase your tax levies to build this building.

- QZAB bond of \$50,000 per year has gone off.
- Capital Outlay Certificates will help pay for this building.
- An earlier addition will have the Capital Outlay certificates expire in 2029
- ESSER funding has helped with flexibility.

The goal is to not increase your tax levies to build this building.

- The current plan is a nice set up.
- There are things within the plan that the board will have the ability to remove (Alternate bids).
- We will also be applying for various grants.

# Timeline:

- Bids will be opened on August 24<sup>th</sup>.
- Board will meet on August 30<sup>th</sup> to decide upon the bids.
- IF passed, digging will begin this fall with hopes that the shell of the building would be intact by mid January.

# Donations to the building/school

- We have been approached about the possibility of donating to the building. This is an option and we will have fliers available in the future.

To prepare and equip our students to become responsible citizens and succeed in an ever-changing world.

Hamlin School Motto